

**Roof Construction**

Pitched roof as indicated with concrete tiles on 50 x 25mm softwood treated battens on 50 x 50mm treated counter battens on 'Tyvek' Supra Plus breather membrane on roof trusses to B.S. 5268 Part 3: 1985.

Wall plates to be 100 x 50mm treated softwood bedded on sand/cement mortar and secured to external walls with 1200mm long by 30 x 5mm galvanised steel vertical restraint straps at 2m maximum centres.

Roof insulation to be 100mm 'Rockwool' insulation laid between ceiling joists with a second layer of 150mm 'Rockwool' insulation laid over joists tucked tightly up against breather membrane to underside of roof covering. Insulation to butt up against cavity wall insulation without a gap.

Construction to achieve minimum 'U' Value of 0.17W/m2K

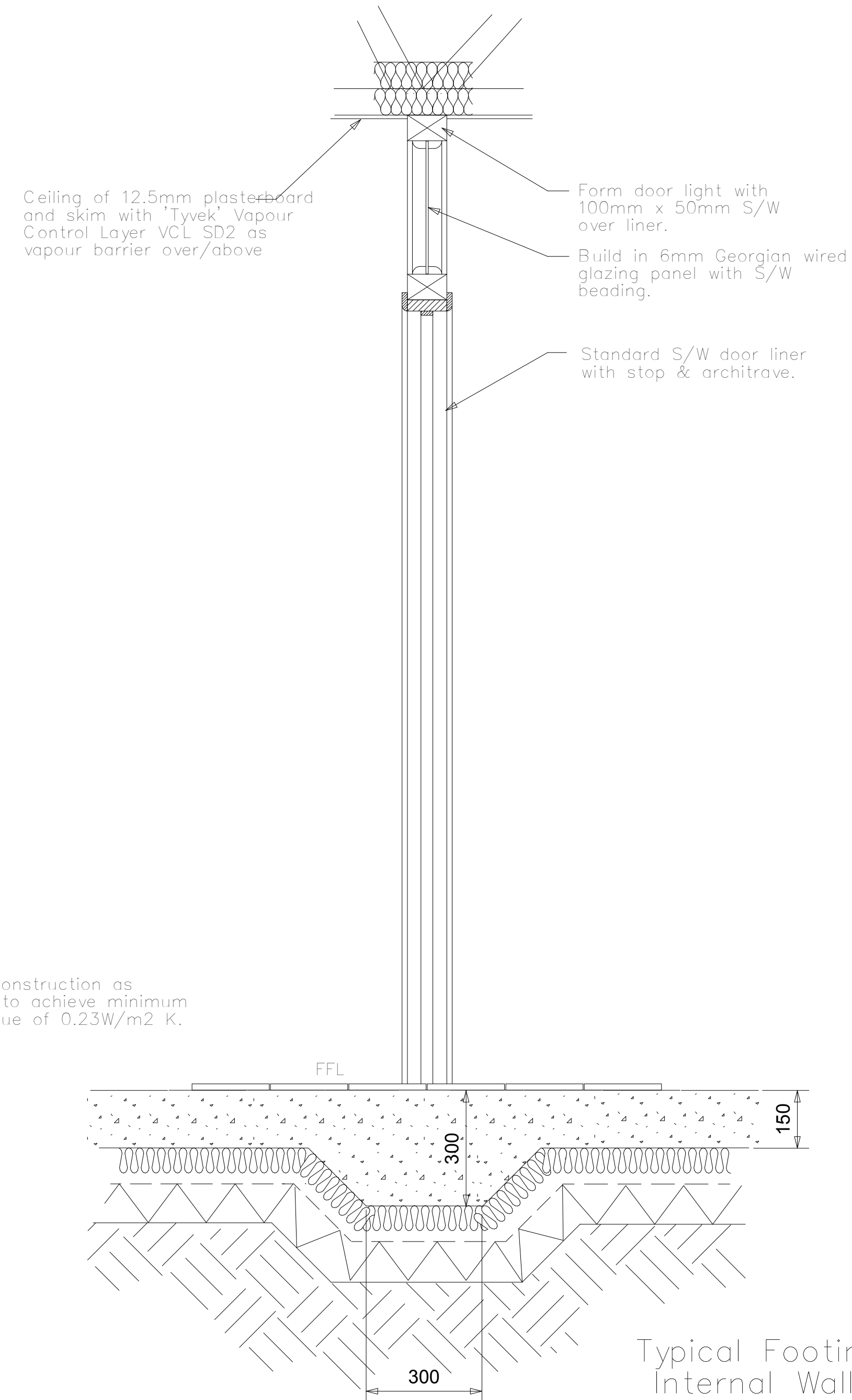

Section Y-Y

**General Notes:**

These notes to be read in conjunction with all other design, architectural and contract documentation relating to this project.

1. All quoted dimensions to be used and no scaled measurements taken. Contractors must check all dimensions on site.

2. The drawings are intended to identify the main features and principle components.

3. All works must be undertaken and supervised by experienced and competent personnel and exhaustive detail is not therefore provided.

4. All work whether indicated or not must comply fully with current Building Regulations, allied legislation and relevant British Standards.

5. All drawings must be checked by the contractor and any discrepancies must be pointed out to the author as soon as is practicable.

| Rev/Date | Detail of Revision |
|----------|--------------------|
| A        | ORIGINAL DESIGN    |

SETAB  
Design Services

Project:  
Hafodyrnyys Rugby Club

Drawing Title:  
Construction Details and Sections

Date: August 2008    Scale: 1:10    Drawn: A J Bates

Drawing No. BD-08005-1    Revision: A    CAD A1 594 x 843mm